

## Riser, J-Tube and Suction Anchor Blanking Plugs

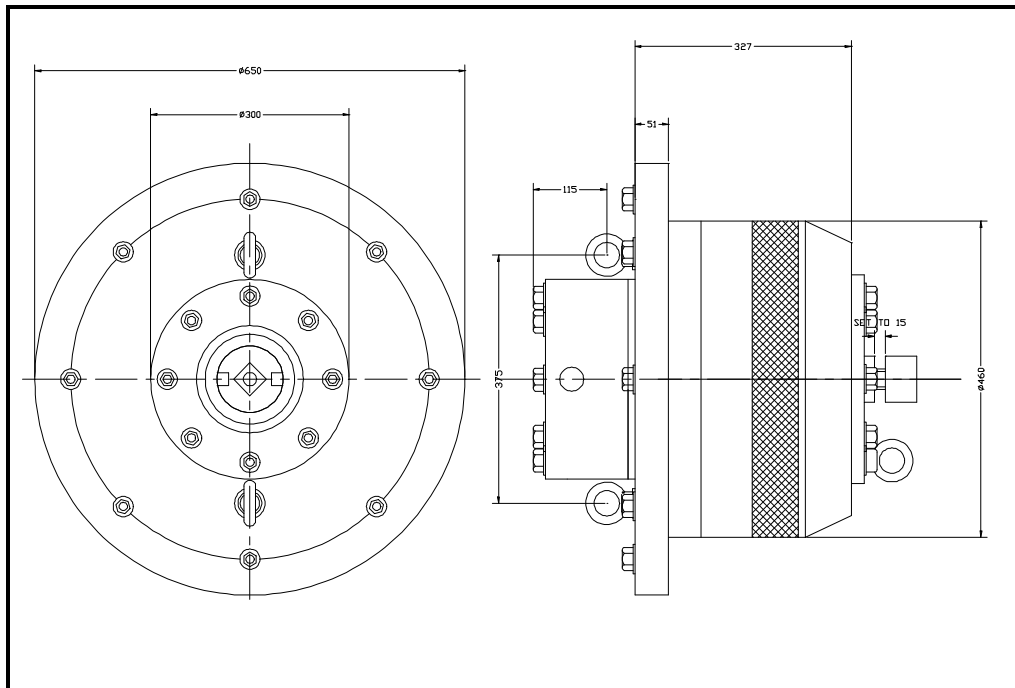

The plugs are designed to be installed and set using a work class ROV equipped with a torque tool. Setting the plug is simply inserting, running up against the pipe shoulder and then torquing up the central drive screw.

The plugs are available in sizes to cover nominal 6" to 30" pipe. The plugs can be configured to interface with flanges, bellmouths or square cut pipe ends. The construction makes maximum use of modern engineering plastics to minimise both the "in air" and "in water" weights to facilitate being carried by the ROV. In shallow water the plugs can be diver installed.



**Typical 20" Riser plug.**

### Size Range

Nominal 6" to 30" pipe

### Pressure Ratings

Typically from 10 bar at 6" to 3 bar at 30"

### Optimisation

The plugs are sized for each installation. This requires information on pipe ID, tolerance and end details such as flange or bellmouth. Higher pressure ratings can be specifically designed for particular applications. Special grabber brackets can be provided to interface with particular ROV carriage constraints.

Specifications are subject to change due to a policy of continuous improvement.  
Please confirm current build standard at time of order.

©2004 Advanced Marine Innovation Technology Subsea Ltd.